

THE MOST INNOVATIVE VIDEO DOOR ENTRY SYSTEM
FOR THE NEW DIGITAL HOME



iLOFT
by **FERMAX**

VIDEO DOOR ENTRY SYSTEMS



ESSENTIAL DESIGN

Compact, extra slim and light. Fastened to the wall. It is **iLoft**, the most innovative FERMAX video door entry system.

The FERMAX proposal for new digital homes. Designed for its user and its new environment.

With **iLoft** comes the perfect balance between the functional security and communication needs of the building and the elegance and integration required by the most state of the art architecture.

iLOFT
by **FERMAX**

Designed by Gae Benedito, Architect. Benedito Design Studio, Barcelona.

FERMAX



iLOFT
by **FERMAX**

NEW MATERIALS



iLoft is a hands free colour video monitor. Compact and extra slim.

New materials and finishing details have been used in its manufacture, giving it a sensitive and delicate character.



Its essential design features a transparent polycarbonate sheet coating a neutral surface, a single audio output, chrome plated buttons for activation of the monitor basic functions and a 4" TFT screen displaying top quality and clarity.

iLOFT
by **FERMAX**

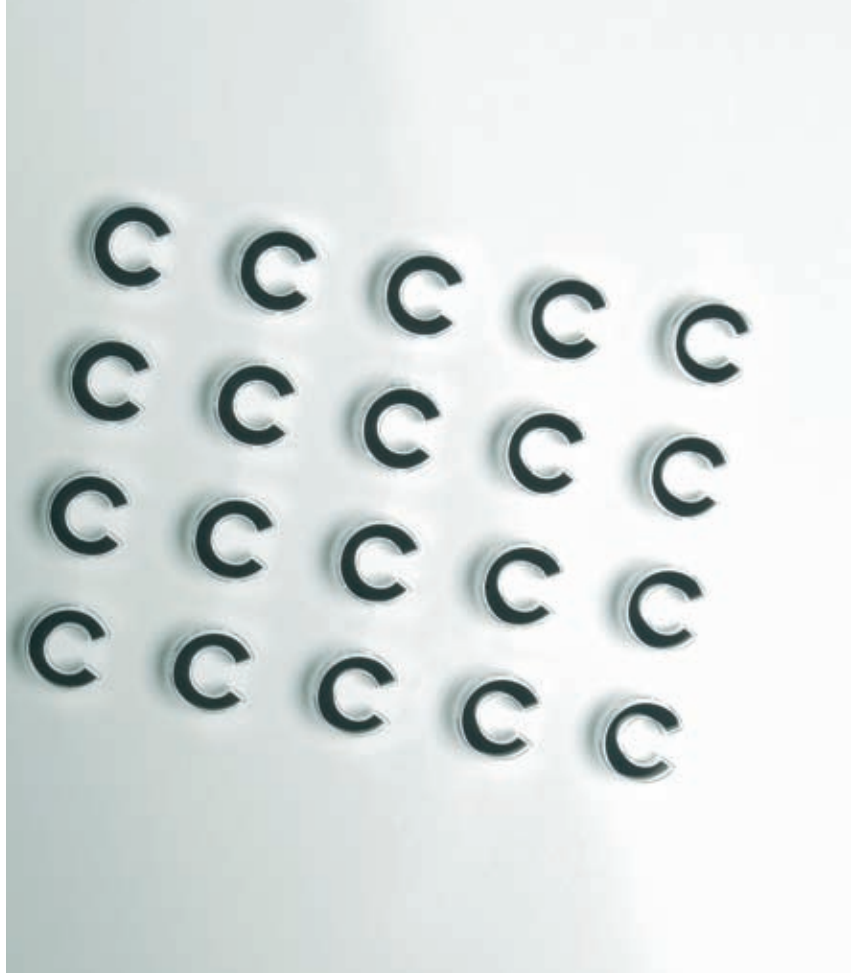



UNIQUE DETAILS





FEATURES AND OPERATION

iLoft is a colour video monitor incorporating a 4" TFT screen and working in hands-free mode.

Upon receiving the call from the outdoor panel, the image appears automatically on the monitor. To communicate with the outdoor panel the button  is pushed, allowing two way conversation (street-home and home-street) in order to speak to the visitor.

iLOFT
by **FERMAX**



F1-F2. Button to activate **additional functions:** stair light switching, 2nd door opening, panic call, etc.

Digital menu ▲ MENU ▼
For adjustment/regulation of internal parameters.

- Call volume control: high and medium, disconnected (do not disturb).
- Melodies ringtone selection: 4 options.
- Brightness/Contrast according to 4 pre-defined backgrounds.
- Colour level according to 4 levels.

Auto start.
Push for 1 sec. to activate the image captured by the outdoor panel.

Activate communication/Hang up.
To activate communication with the outdoor panel and to finish communication*.

Microphone

4" TFT Screen
Upon receiving a call, the image appears automatically.

Loudspeaker output.

Status Led.
Communicating (blue).
Standby (red).

Door opener button.
Pushbutton to open the door and to call the guard.

* The monitor contains an internal timer that automatically deactivates communication 90 seconds after its initialization, thus preventing the monitor from staying active.

PROGRAMMING

The **iLoft** monitor is a digital video door entry system that must be programmed according to the number of the house where it is installed.

It contains an innovative system that allows programming from the monitor itself once installed, with no need to operate from the outdoor panel. To do so, lift the cover and push the programming button, then through the digital menu ▲ MENU ▼ select the door number to which this monitor corresponds until it is visualized in the display screen the monitor contains.



INSTALLATION. 5 STEPS

1 Install the FERMAX flush-mount box or a standard box (measures: 174(H)x114(W)x50(D) mm). **2** Connect the wires from the installation to the terminal strip of the monitor. **3** Screw the monitor to the flush-mount box and programme with the home number. **4** Assemble the cover and fold it down. **5** Adjust the volume/backgrounds/colour level.

1

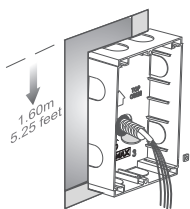

2

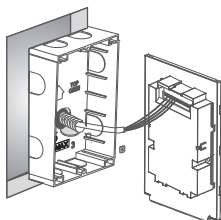

3

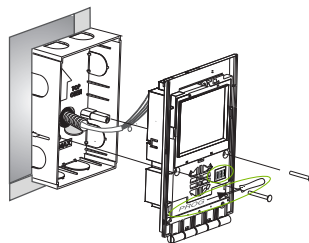

4

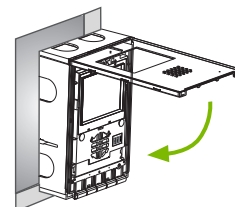

5

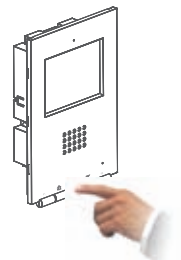

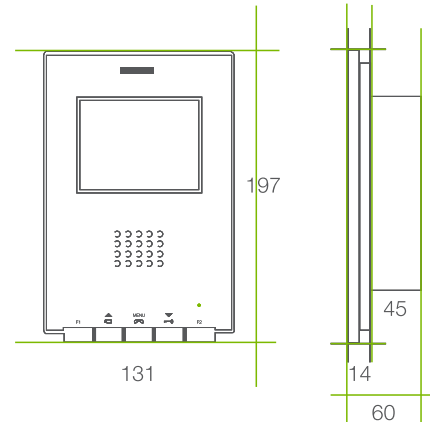

Measures in mm.

TECHNICAL SPECIFICATIONS

TFT	Flat screen. 4" Diagonally
RESOLUTION	480(W)x234(H) lines
POWER SUPPLY	18Vdc
CONSUMPTION	Standby: 15 mA Call: 300 mA Conversation: 400 mA
DIMENSIONS	Monitor: 131(W)x197(H)x60(D)mm Fermax flush-mounted box: 158(W)x108(H)x45(D)mm Standard box (maxim. size): 174(W)x114(H)x50(D)mm
INSTALLATION	Flush mount. 14mm protrusion from the wall once fitted.
REGULATION	Brightness/contrast/volume through internal digital potentiometers.

The **iLofT** monitor is compatible with standard flush-mounted boxes measuring: 174(W)x114(H)x50(D)mm.

iLOFT
by **FERMAX**

www.fermax.com